



● 超低インピーダンス

ATWB シリ - ズ JIS C5101

CE-04
(耐洗浄品)

■ 特徴

- 105°C、2,000 時間保証の Ultra Low Impedance です。
- VRM 回路用低インピーダンス。

■ 寸法図/DIAGRAM OF DIMENSIONS

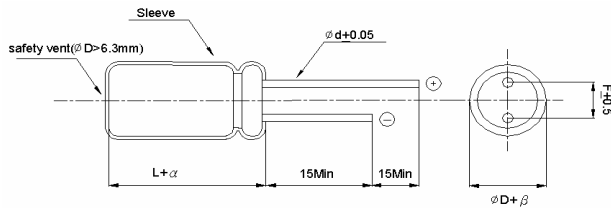

Unit : mm

ΦD	8	10
F	3.5	5.0
Φd	0.6	
	L=11.5, Φd=0.5	
α	1	
β	0.5	

■ 性能/PERFORMANCE SPECIFICATION

カテゴリ温度範囲	CATEGORY TEMPERATURE RANGE	-25~+105°C								
標準静電容量許容差	STANDARD CAPACITANCE TOLERANCE	-20%~+20% (120Hz)								
漏れ電流 (最大値)	LEAKAGE CURRENT (MAX. VALUE)	I = 0.03CV WHICHEVER IS GREATER (AT 20°C, AFTER 2 MINUTES) C: RATED CAPACITANCE (uF) V: WORKING VOLTAGE (V)								
損失角の正接 (最大値) (tan δ)	DISSIPATION FACTOR (MAX. VALUE)	<table border="1"> <tr> <td>W. V.</td> <td>4</td> <td>6.3</td> <td>10</td> </tr> <tr> <td>tan δ</td> <td>0.3</td> <td>0.22</td> <td>0.19</td> </tr> </table> <p>When nominal capacitance is over 1000uF, tan δ shall be added 0.02 to the listed value with every increase of 1000uF</p>	W. V.	4	6.3	10	tan δ	0.3	0.22	0.19
W. V.	4	6.3	10							
tan δ	0.3	0.22	0.19							
耐久性 105°C 2000 時間 定格使用電圧印加	ENDURANCE APPLICATION OF RATED OPERATING VOLTAGE, AT 105°C FOR 2000 HOURS	CAPACITANCE CHANGE : WITHIN ±30% (L=8*9 : ±40%) OF THE INITIAL VALUE DISSIPATION FACTOR : 200% OF THE INITIAL SPECIFIED VALUE OR LESS LEAKAGE CURRENT : THE SPECIFIED VALUE OR LESS								
低温特性 (+20°Cにおける120Hzのインピーダンスに対する比)(最大値)	LOW TEMPERATURE STABILITY (RATIO OF IMPEDANCE AT COLD TO THAT AT 20°C, 120Hz. MAX. VOLUE)	<table border="1"> <tr> <td>W. V.</td> <td>-25°C/+20°C</td> </tr> <tr> <td>4.0</td> <td>3</td> </tr> <tr> <td>6.3</td> <td>3</td> </tr> <tr> <td>10</td> <td>3</td> </tr> </table>	W. V.	-25°C/+20°C	4.0	3	6.3	3	10	3
W. V.	-25°C/+20°C									
4.0	3									
6.3	3									
10	3									
その他の特性は JIS C5101-4 に準ずる	THE OTHER CHARACTERISTICS	THE OTHER CHARACTERISTICS ARE BASED ON JIS C 5101-4								

■ 定格リップル電流補正係数

リップル周波数が標準品一覧表の規定値と異なる場合には、下表の係数を乗じた値以下でご使用下さい。

When the ripple frequency differs from the specification shown in the list of standard products, multiply the value with the coefficient shown below, and use the products under the obtained value.

周波数補正係数/FREQUENCY CORRECTION FACTOR

Frequency(Hz)	120	1K	10K	100K
Coefficient	0.50	0.80	0.90	1.0

■ Standard Rating

Ripple* : Rated Ripple Current (105°C 100kHz, MAX)

Capacitance (μF)	4.0V (0G)			6.3V (0J)			10V (1A)		
	ΦD×L (mm)	Impedance (Ω/100kHz)	Ripple* (mA) 100kHz	ΦD×L (mm)	Impedance (Ω/100kHz)	Ripple* (mA) 100kHz	ΦD×L (mm)	Impedance (Ω/100kHz)	Ripple* (mA) 100kHz
560	8 x9	0.028	750						
680	8 x9	0.028	750						
820	8 x9	0.028	750						
1000	8 x11.5	0.025	1300	8 x11.5	0.025	1300	8 x20	0.015	2100
1500	8 x20	0.015	2100	8 x20	0.015	2100	10 x20	0.012	2800
2200	10 x20	0.012	2800	10 x20	0.012	2800	10 x25	0.011	3230
3300	10 x25	0.011	3230	10 x25	0.011	3230			