

MiraScreen

Wireless Display

Bring smart phone entertainment to the big screen!

User manual

Ver. B 1.0

Instruction

MiraScreen is a wireless screen mirroring receiver. With MiraScreen users can easily cast videos or games from a small screen to a big screen. MiraScreen supports multi OS mirroring which including Windows, macOS, Android, and iOS. Ongoing free firmware is provided to catch up latest devices. Please follow the user guide below to complete the setup. Happy Mirroring!

Dos and Don'ts and Troubleshooting

1. This device is used for transmission of data via WiFi. Please don't cloak the device with metal.
2. The device is poor in wall-penetrating capability. Please don't use it where there are partition walls.
3. For the availability of a good experience, the phone or computer is ideally 3-5 meters away from the device.
5. If the TV interface still does not display properly or SSID, Password, IP still don't appear after replacing the 5V2A power adapter, please contact After-Sales via post-sales email and we will address your issues as soon as possible.

Technical support email: Support@MiraScreen.com

1. Hardware Installation

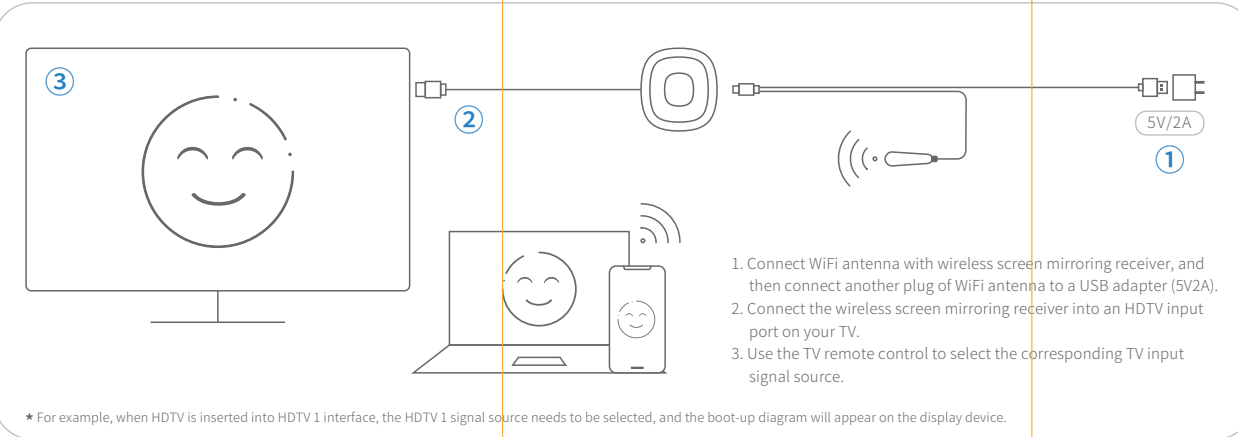

2. Device Network Settings

Connect to Home Router WiFi

When using it for the first time, please give priority to connecting the device to the home WiFi router

1. Click WiFi on the phone settings page, Find MiraScreen device from WLAN (Name is MiraScreen-xxxx Default password is 12345678).
 2. Turn on Phone / Pad Browser, input 192.168.203.1
 3. Click WiFi AP, and Scan, Choose available WiFi.
 4. Connect Input password and click Connect.
- * The function applies to: iPhone/iPad/Android Devices.

User Interface Introduction

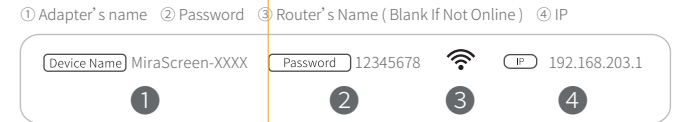

3. Mirroring Setup

Setup for iOS

Direct Connect for iOS

1. From iPhone / iPad's Setting/WiFi, find the Hot Spot of MiraScreen and connect it.
For example: MiraScreen-XXXX.
Default Password: 12345678(Modifiable)

* Make sure both dongle and mobile phone are connected to the same router wifi.

2. Slide Screen and go to Apple's control center, click "Airplay Mirroring", then select MiraScreen

Setup for macOS

Direct connection for macOS

1. Turn on MacBook wifi to discover MiraScreen network (MiraScreen-xxxx for example) and tap the network to connect.
Default password is 12345678.

2. Turn on Airplay mirroring icon on the right top of the desktop corner. Tap MiraScreen name to connect, and then mirroring works.

Setup for Android

Method 1

1. Open the phone settings → find wireless screen mirroring/wireless display/ wireless sharing/multi-screen interaction, etc.
2. Search for MiraScreen wireless screen mirroring device and connect

Different brands of mobile phones/tablets wireless screen mirroring function setting path:

HUAWEI : Setting > Smart Assist > Multi-screen Interactive

Xiaomi : Settings>Connection&Sharing>Cast (Turn on cast)

OnePlus : Settings - Bluetooth & device connection - cast

OPPO : Settings>Other wireless connections>ScreenCast

MEIZU : Setting-Display > Projection Screen

Lenovo : Setting Display > Wireless Display

SAMSUNG : Phone From Top To Bottom > Smart View

VIVO : Settings>Other networks and connections>Smart Mirroring>Connect to a TV> Setting icon (Right top corner)>Screen mirroring

For more models, please contact customer service email

Method 2 How to use Google home (please confirm that the device is connected to the home WiFi router) (please confirm that your purchased product and mobile phone support Google home function)

1. Turn on the Android phone WiFi and confirm that the phone WiFi and the device are connected to the same WiFi router network.
2. Open Google Home, search the device SSID (name of device WiFi), and Click it to implement screen mirroring be found please refresh the homepage of Google Home, verify that your home WiFi appears in the upper right corner of the TV interface and that your Android phone and device are connected to the same network, after restarting your phone or device).

Setup for Windows

Method 1 Windows8.1/10 Operational Steps

1. Click on "Operation Center"
2. Select Connection
3. Find the MiraScreen device and click connect
4. Start to connect

Windows7 and above system operation steps

1. Download EZMira software installation.
2. Click WiFi, find the MiraScreen hotspot and connect.
Such as: MiraScreen-XXXX Password: 12345678
3. Select Search Device, click the SSID name of the device to connect Screen Mirroring
4. To connect to the network, click the EZMira icon > Settings > Internet > select the connected WI-FI name> enter the password and connect

Method 2 How to use Google chrome.

Ensure that your PC WiFi is connected to your home WiFi and click the Google chrome contribution in the upper right corner of the Google chrome interface, select Cast, and then select SSID (name of the WiFi device) while waiting for search.(If the device SSID is not found, please verify that your home WiFi name appears in the upper right corner of your home TV interface and that your PC and the device are connected to the same network, after restarting your PC or device).

More advanced settings

EZMira Software Download

PC Request URL:
<https://mirascreen.com/pages/download-ezmira-for-windows>

Mobile phone Request URL:
<https://mirascreen.com/pages/download>

please scan the QR code on the TV screen to download EZMira app Mobile phone users can also download the "EZMira" App in Google Play.

How to use the screen mirroring device's EZMiraAPP

1. Open EZMira APP and click "EZMira APP".
2. Select MiraScreen.

Wireless network selection (2.4G/5G) (2.4G version users please ignore this option)

MiraScreen devices will operate on the same wireless frequency band as the home router. To use a 5G wireless network, please connect the MiraScreen device to the 5G band of your home router.

无线同屏器

享受小屏幕变大屏幕的尊贵体验!

用户手册

Ver. B 1.0

请仔细阅读本说明书后正确使用,并妥善保管。

产品简介

MiraScreen 无线同屏器搭配现有DLNA, Miracast, Airplay镜像, EZMira等投屏协议, 能实现小屏幕到大屏幕的转变, 让生活变得丰富多彩。无线同屏器支持多平台系统投屏, 苹果手机/平板, 安卓手机/平板, Windows电脑, Mac电脑都支持。免费固件将不定期发布供用户在线下载, 用于兼容最新的各平台操作系统, 让同屏更稳定, 体验更精彩。Happy Mirroring!

注意事项以及故障排除

1. 该设备属于WiFi传输数据, 请勿用金属将设备笼罩。
2. 该设备WiFi穿墙能力较差, 请勿隔墙使用。
3. 为了让您有一个好的使用体验, 手机或电脑离设备最好是在3-5米的距离。
4. 设备启动后, 请第一时间确认电视界面SSID, Password, IP等均正常显示, 这非常重要。
5. 如果更换5V2A电源适配器后, 电视界面依然不能正常显示或不能出现SSID, Password, IP。 请通过售后邮箱联系售后客服, 我们将第一时间为您解决使用问题。

技术支持邮箱: Support@MiraScreen.com

1. 硬件安装

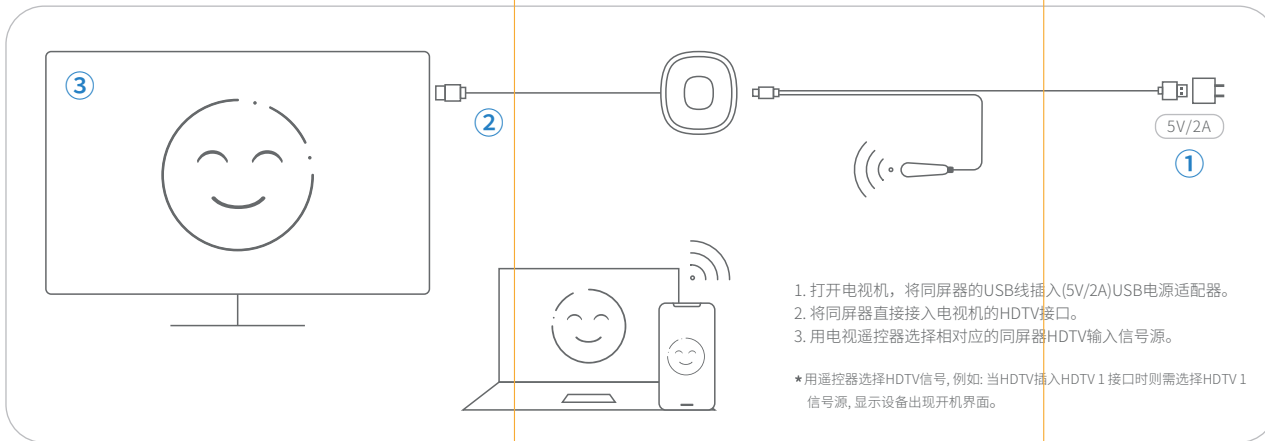

2. 设备网络设置

连接家用WIFI路由器

首次使用时请先将设备连接至家庭WIFI路由器

1. 在手机设置页面中点击WiFi, 找到并连接MiraScreen设备(名称是: MiraScreen-xxxx, 默认密码为12345678)。
2. 打开手机/平板浏览器, 输入192.168.203.1
3. 点击互联网, 选择家庭路由器WiFi名。
4. 输入家庭路由器无线WiFi密码, 点击确定。

*此设置适用于:iPhone/iPad/Android 等设备。

开机界面介绍

- ① 同屏器名称 ② 同屏器密码 ③ 家庭路由器名称(未连接网络不显示) ④ IP后台设置界面



3. 使用方法

苹果iOS系统 — 镜像操作步骤

iOS系统连接

1. 在手机设置页面中点击WiFi, 找到 MiraScreen的热点并连接。
例如: MiraScreen-XXXX 固定密码:12345678(可修改) 或确保手机和设备WiFi连接在同一家庭路由器上。



2. 滑动屏幕进入苹果设备控制中心, 点击屏幕镜像, 勾选MiraScreen 设备。



苹果电脑 — 镜像操作步骤

苹果笔记本OS系统连接

1. 点击WiFi, 找到 MiraScreen 的热点并连接例如: MiraScreen-xxxx 固定密码:12345678



2. 点击桌面左上角“屏幕镜像” > 勾选MiraScreen 设备 > 开始同屏



安卓系统 — 镜像操作步骤

方法一

1. 打开手机设置 → 找到 无线投屏/无线显示/无线分享/多屏互动 等...
2. 搜索MiraScreen无线同屏器并连接

不同品牌手机/平板无线投屏功能设置路径:

- 华为: 下拉菜单-无线投屏/多屏互动
- 小米: 设置-连接与共享-投屏
- 三星: 手机从上往下滑- Smart View
- 魅族: 设置-显示-投射屏幕
- 联想: 设置-显示-无线显示
- 锤子: 无线网络-无线显示
- vivo: 设置-其它连接方式-智慧投屏-屏幕镜像
- OPPO: 设置-更多连接方式-智慧投屏/多屏互动.....

更多机型请联系客服邮箱

方法二 Google home使用方法 (请确认设备已连接到家庭WiFi路由器)(请确认您所购买的产品和手机支持Google home功能)

1. 打开Android手机WiFi, 确认手机WiFi与设备连接到同一WiFi路由器网络。
2. 打开Google home, 等待大概10秒, 搜索到设备SSID (MiraScreen-xxxx) 点击即可实现屏幕镜像。(如无法搜索到设备SSID, 请刷新Google home主页, 请确认电视界面右上角出现您家里的WiFi, 确认Android手机与设备连接到同一网络, 或重启您的手机和设备)。

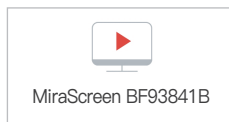

Windows — 镜像操作步骤

方法一 Windows8.1/10系统操作步骤



1. 点击“操作中心”
2. 选择连接
3. 搜索到MiraScreen设备点击连接
4. 开始同屏

Windows7以上系统操作步骤

1. 下载 EZMira APP 软件安装好。
2. 点击WiFi, 找到 MiraScreen 的热点并连接。
如: MiraScreen-XXXX 密码:12345678
3. 选择搜寻设备, 点击设备SSID名称即可同屏。
4. 如需连接网络, 点击 EZMira图标 > 设定 > 互联网 > 选择连接的WiFi名称 > 输入密码并连接即可。

方法二 Google chrome使用方法,

确认您PC的WiFi连接到您家里的路由器, 在Google chrome界面右上角点击控制Google chrome按钮, 选择投射, 等待搜索并选择SSID(设备WiFi名称) 如无法搜索到设备SSID, 请确认电视界面右上角出现您家里的WiFi名称, 请确认您的PC已经与设备连接到同一网络, 或重启您的电脑和设备)。



更多高级设置

EZMira软件下载

PC端访问网址:
<https://mirascreen.com/pages/download-ezmira-for-windows>
手机端访问网址:
<https://mirascreen.com/pages/download>
手机用户可扫描屏幕上的二维码下载, 也可以在腾讯应用宝/360手机助手/手机自带的应用商店中搜索"EZMira"下载。

同屏器如何使用EZMiraAPP

1. 打开EZMira APP, 点选“易连APP”。

易连同屏

2. 选择 MiraScreen。

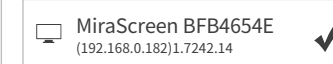

无线网络选择 (2.4G/5G) (2.4G版本用户请忽略此项)

MiraScreen设备会选用跟家庭路由器相同的无线频段运行。需要使用 5G 无线网络, 请把 MiraScreen 设备连接到家庭路由器的5G频段。